



INTEGRATED CASH DRAWERS
UNDER-THE-COUNTER CASH DRAWERS
TABLE TOP CASH DRAWERS

INSTRUCTIONS
FOR SECURE CASH DRAWERS

Copyright – 2002 Mogler-Kassen GmbH, Rappenu
Printed in Germany
All rights reserved

This document may not be reproduced in any form, either in part or in whole, translated into other languages or distributed to third-parties without the prior written consent of Mogler-Kassen GmbH.

Mogler-Kassen GmbH
Obere Mühle 17
D-74906 Bad Rappenu-Bonfeld, Germany
Phone +49 (0) 70 66 99 44-10
Fax +49 (0) 70 66 99 44-11

Internet: <http://www.mogler.de>
E-mail: technik@mogler.de

Edition 1.0
03/2002

Table of Contents

Introduction **I**

General I

Guarantee I

Installation I

 Opening the Cash Drawer for the First Time 2

 Drawers with Beech Wood Front Panels 2

 Removing the Cash Drawer 3

 Table Top/Under-The-Counter Cash Drawer 3

 Integrated Cash Drawer 3

 Reduced-Depth Cash Drawers 3

 Installing the Cash Drawer 4

 Under-The-Counter Cash Drawer 4

 Integrated Cash Drawer 4

 Integrated Reduced-Depth Cash Drawers 5

 Reduced-Depth Cash Drawers with Mounting Frame (Under-The-Counter Model) 5

 Inserting the Cash Drawer 6

 Table Top/Under-The-Counter/Integrated Cash Drawer 6

 Reduced-Depth Cash Drawers 6

Operation **7**

Activating the Security Alarm Lock 7

 Testing 8

- Opening the Cash Drawer 9
 - Cash Drawer with Security Alarm Lock 9
 - Cash Drawer without Security Alarm Lock 9
- Cylinder Lock 10
 - Cash Drawers with Beech Wood Front Panels 10
- Models With Lockable Drawer Inserts (DI) 11

Maintenance 12

Trouble Shooting 13

- Alarm does not go off. 13
- The drawer will not enter the housing 14
 - After inserting the drawer in the housing 14
 - After setting the key combination for the lock. 14
 - Cash Drawer With Insert 14
 - Other Causes 15
- Lock key head is broken 15
 - Table Top/Under-The-Counter Cash Drawer 15
 - Reduced-Depth Cash Drawers with Beech Wood Front Panels. 16
- Other. 16
 - The key is broken. 16
 - Forgotten key combination 16

Appendix 17

- Replacement Parts 17
- Accessories 18

I Introduction

I.1 General

- Please read the instructions **before** installing or using the cash drawer for the first time.
- Kindly observe the maintenance instructions (see Section 3.1).
- Lock the cash drawer with the cylinder lock as well before leaving it unattended.

I.2 Guarantee

All Mogler cash drawers are covered by a 12 month guarantee.

Please note that improper handling or failure to observe the instructions will render warranty claims void. Mogler is not liable for damages or losses due to improper operation.

I.3 Installation

The cash drawer is locked upon delivery.

Before assembling any cash drawer type, you must first remove the drawer (see Section 1.3.2).

Cash Drawers with Mechanical Release

I.3.1 Opening the Cash Drawer for the First Time

The cash drawer key is located in the envelope with the instruction manual.

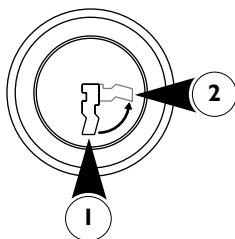

- Unlock the cylinder lock.
 - Vertical key position **1** = drawer unlocked
 - Horizontal key position **2** = drawer locked
- Grasp the handle and pull the drawer out of the housing.

Drawers with Beech Wood Front Panels

- Unlock the cylinder lock.
 - Key position **1** = drawer locked
 - Key position **2** = drawer unlocked
- Grasp the handle and pull the drawer out of the housing.

1.3.2 Removing the Cash Drawer

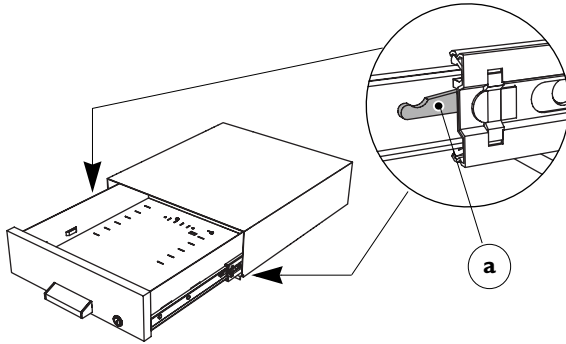
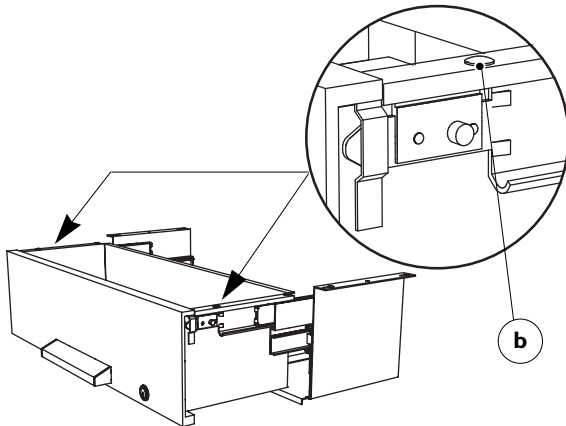

Table Top/Under-The-Counter Cash Drawer

- Pull the drawer out as far as possible.
- Press the plastic lever **a** as far as it will go (down on the right and up on the left side of the drawer) and then pull the drawer out.
- The drawer can now be removed from the rails.

Integrated Cash Drawer

- Proceed as outlined in the instructions for table top and under-the-counter cash drawers.



Reduced-Depth Cash Drawers

- Pull the drawer out as far as it will go.
- Pull the drawer gently to bypass the incorporated spring blocking mechanism.
- Now pull the drawer out as far as it will go again.
- Press both lock knobs **b** on the top edges of the drawer and pull the drawer towards you.

Telescopic Rails Without Plastic Lever (a)

- Pull the drawer out as far as it will go.
- Free the drawer from the rails with a firm tug.

Cash Drawers with Mechanical Release

I.3.3 Installing the Cash Drawer

- ! To install the cash drawer unit, use screw with heads that are as flat as possible to ensure the smooth movement of the sliding drawer.

Under-The-Counter Cash Drawer

- Fasten the under-the-counter cash drawer unit to the base plate using drill holes **c** and keyholes **d**.

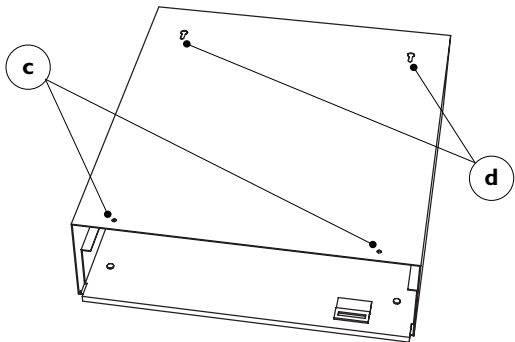

Integrated Cash Drawer

- Fasten the housing to the base plate using drill holes **e** and keyholes **f**.

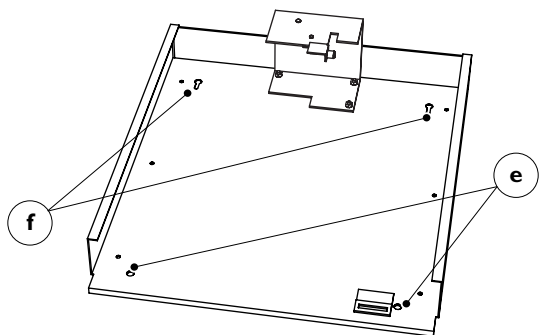

Integrated Reduced-Depth Cash Drawers

- Fasten the housing to the base plate using drill holes **g** and keyholes **h**.

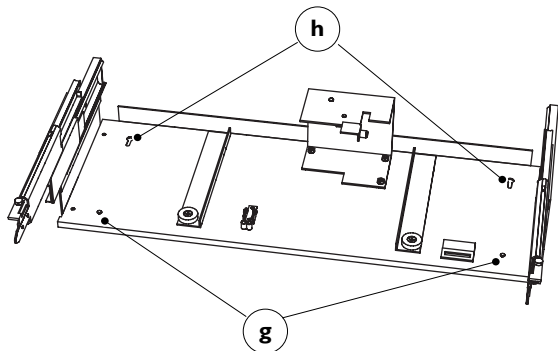

Reduced-Depth Cash Drawers with Mounting Frame (Under-The-Counter Model)

- Mount the cash drawer unit to the base plate using keyholes **i** on mounting frame **k**.

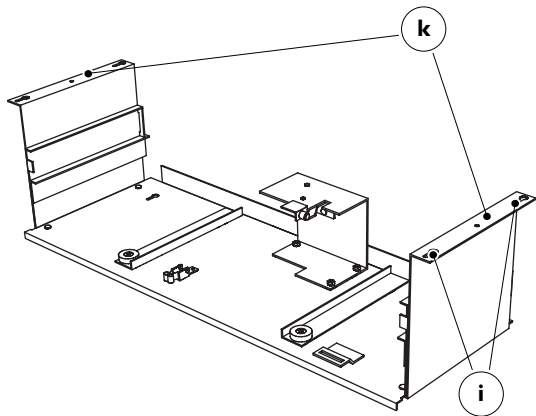

Cash Drawers with Mechanical Release

I.3.4 Inserting the Cash Drawer

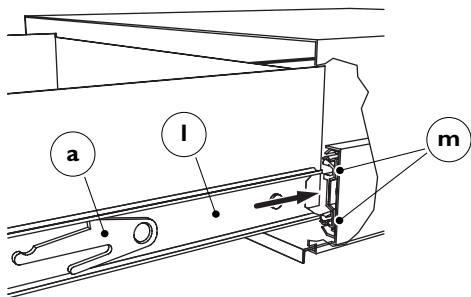

! Never apply force to close a cash drawer.

Table Top/Under-The-Counter/Integrated Cash Drawer

- Push the telescopic rails into the cash drawer housing as far as they will go.
- Insert guide rails **l** on the side of the drawer into openings **m** on the telescopic rails.

! Be careful not to twist or tilt the drawer.

- Close the cash drawer. The rails are automatically blocked.

Reduced-Depth Cash Drawers

- Pull the guide rails out as far as they will go.
- Place the drawer on the rails.
- Hold the rails using knobs **n** and insert tongue **o** into the supports labelled **l**.
→ Lock knobs **q** should automatically latch into the holes in the drawer.
- Push the drawer gently to overcome the incorporated spring blocking mechanism.
- Close the cash drawer.

Telescopic Rails Without Plastic Lever (a)

- Push the telescopic rails into the cash drawer housing as far as they will go.
- Guide the drawer onto the rails with a firm push.

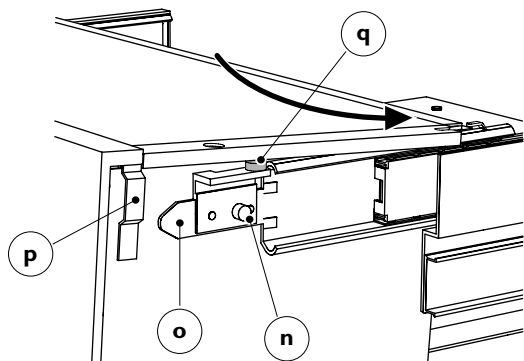

2 Operation

2.1 Activating the Security Alarm Lock

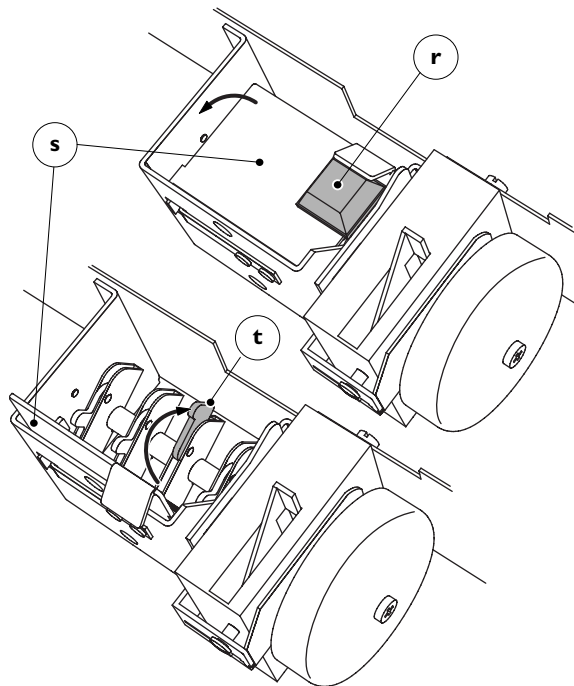

The procedure for activating the security alarm lock is the same for all models.

- Using a screwdriver, remove the transport protector (**r**) from the protective plate (**s**) on the lock box.
- Open the protective plate until it is in the vertical position.
- Position the lock levers (for example, **t**) towards the rear of the lock box according to the desired key combination.
 - Depending on the number of lock levers activated, various combination settings are available:

After activating			
One Lock Lever	Two Lock Levers	Three Lock Levers	Four Lock Levers
The following key combinations are available:			
1	1 • 2	1 • 2 • 3	1 • 2 • 3 • 4
2	1 • 3	1 • 2 • 4	
3	1 • 4	1 • 3 • 4	
4	2 • 3	2 • 3 • 4	
	2 • 4		
	3 • 4		

Cash Drawers with Mechanical Release

- Return protective plate **s** to its original horizontal position.

Testing

- Press the hidden keys under the handle using the combination you selected.
 - The protective plate is lowered slightly.
- Close the drawer without touching any buttons.

2.2 Opening the Cash Drawer

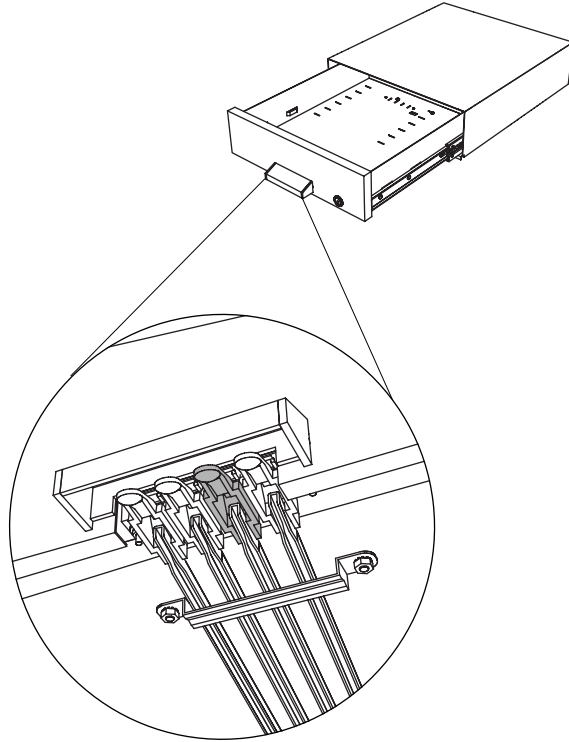

Cash Drawer with Security Alarm Lock

The procedure for opening the cash drawer is identical for all models with a security alarm.

- Press the hidden keys under the handle using the combination you selected.
 - You can now remove the drawer without any difficulty.
 - Close the drawer by pushing it closed.
 - The alarm's spring mechanism is self-winding (to guarantee continuous operation).
 - If you press an incorrect key combination:
 - The alarm is triggered (approx. 90 seconds).
 - The drawer cannot be removed.
 - Press the correct key combination and pull the drawer out at the same time.
 - The alarm is turned off.
 - Close the drawer.
- ! All cash drawers can also be secured using the cylinder lock (for example, when the place is left unattended).

Cash Drawer without Security Alarm Lock

- Grasp the handle and pull the drawer out of the housing.
- ! The cylinder lock is the only security device.

2.3 Cylinder Lock

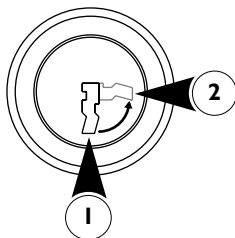

Table Top/Under-The-Counter Cash Drawer

Both cash drawer models can be locked or opened using a cylinder lock with two key positions:

- Vertical key position **1** = drawer unlocked
- Horizontal key position **2** = drawer locked

! Remove the key after unlocking the cash drawer: This will prevent the cash drawer from being locked if the key is accidentally turned and avoid accidental breakage of the key.

! Never leave a key in the cash drawer!

Cash Drawers with Beech Wood Front Panels

Cash drawers with beech wood front panels can be locked or opened using a cylinder lock with two key positions:

- Key position **1** = drawer locked
- Key position **2** = drawer unlocked

! Remove the key after unlocking the cash drawer: This will prevent the cash drawer from being locked if the key is accidentally turned and avoid accidental breakage of the key.

! Never leave a key in the cash drawer!

2.4 Models With Lockable Drawer Inserts (DI)

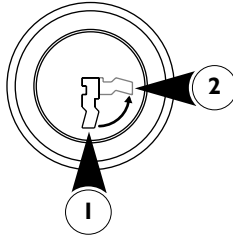

Always remove the cover before placing the insert into the cash drawer.

- Unlock the lock on the cover of the insert.
 - Vertical key position **1** = cover locked
 - Horizontal key position **2** = cover unlocked
- Raise the cover to clear the lock and then remove it.
- Place the insert into the drawer.
- To close the insert cover again, remove the insert from the cash drawer.
- Ensure that the cover is resting on the edge of the insert before shutting it.
- Close the lock.

3

Maintenance

! Keep the guide rails and ball bearings clean.

If dirt should hinder smooth operation of the cash drawer:

- Remove the cash drawer (see Section 1.3.2).
- Clean the telescopic rails.
- Coat the rails and ball bearings with a non-hardening ball bearing grease.

4

Trouble Shooting

4.1 Alarm does not go off.

Possible cause: Alarm bell is defective.

- Replace the alarm bell (see Section 5.1).

Possible cause: Broken winding bracket tension springs

- Remove the cash drawer (see Section 1.3.2).
- Remove the cash drawer housing (see Section 1.3.3).

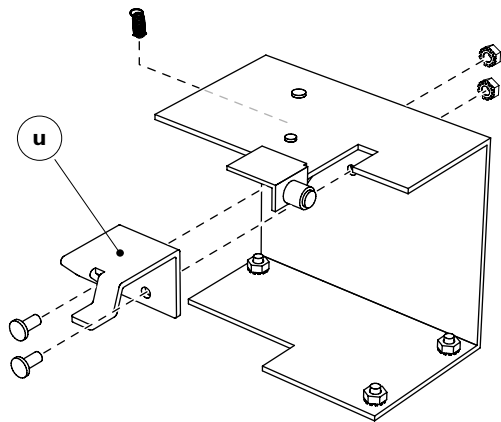

Table Top/Under-The-Counter Cash Drawer

- Remove the six nuts under the base plate of the cash drawer housing.
- Remove the base plate from the housing.
- Remove the nuts on bracket **u**.
- Replace the tension springs.
- Reassemble all components in reverse order.
- Reinstall the cash drawer (see Section 1.3.4).

Integrated/Reduced-Depth Cash Drawers with Under-The-Counter Mount

- Remove the nuts on bracket **u**.
- Replace the tension springs.
- Reassemble all components in reverse order.
- Reinstall the cash drawer (see Section 1.3.4).

4.2 The drawer will not enter the housing

After inserting the drawer in the housing

Possible cause: The drawer has been twisted or tilted

- Remove the cash drawer.
- Insert the cash drawer again.

After setting the key combination for the lock

Possible cause: The protective plate on the lock box is still in the vertical position.

- Grasp the handle and pull the drawer out of the housing.
- Ensure the protective plate is in the horizontal position.

Cash Drawer With Insert

Possible cause: The cover is not placed correctly on the drawer insert.

If you wish to store a covered insert in the cash drawer, you must make sure that the cover is correctly positioned on the insert.

- Place the cover on the insert again.

Possible cause: Insert was not placed in the drawer correctly.

- Remove the drawer insert.
- Check that there are no objects below the drawer insert.

Other Causes

Possible cause: Lock is closed.

- Check that the lock is in the unlocked position.

Possible cause: Objects are blocking the drawer.

- Ensure that there are no objects behind the cash drawer.

Possible cause: The guide rails or ball bearings are dirty.

- See Maintenance (Section 3)

Possible cause: Lock keys were pressed

- Be careful not to press any of the keys when closing the drawer.

4.3 Lock key head is broken

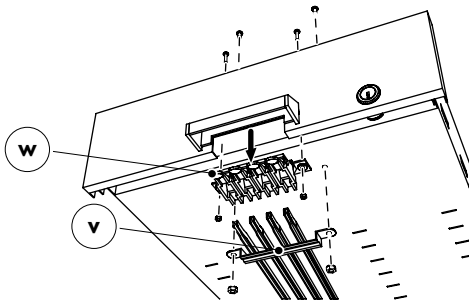
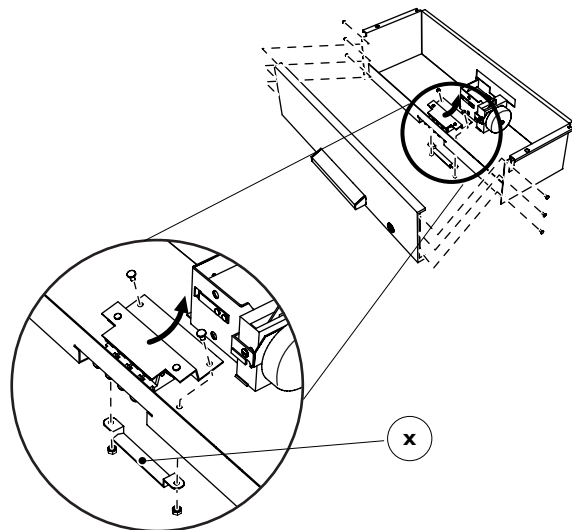

Table Top/Under-The-Counter Cash Drawer

- Remove the cash drawer (see Section 1.3.2).
- Remove the nuts on support bracket **v** under the drawer.
- Remove the nuts on lock key holder **w**.
- Replace the broken button.
- Position the key lock lever on the corresponding keys.
- Reassemble all components in reverse order.
- Reinstall the cash drawer (see Section 1.3.4).

Cash Drawers with Mechanical Release



Reduced-Depth Cash Drawers with Beech Wood Front Panels

- Remove the cash drawer (see Section 1.3.2).
- Remove the beech wood panel (see illustration).
- Remove the nuts on support bracket **x** under the drawer.
- Remove the key block from the drawer.
- Insert the new key block.
- Position the key lock lever on the corresponding keys.
- Screw on support bracket **x**.
- Reinstall the cash drawer (see Section 1.3.4).

4.4 Other

The key is broken

- Please contact your dealer.

Forgotten key combination

- Please contact Mogler.

5 Appendix

5.1 Replacement Parts

When ordering replacement parts, please specify the item number, cash or drawer type and the serial number.

Fig.	Item No.	Description
1	900-200	Cylinder Lock with Lock Spring
2	900-201	Key Set (4 Pieces)
3	900-202	Lock Box
4	900-203	Alarm Bell
5	900-204	Winding Bracket Tension Springs
6	900-205	Stop Bracket
7	900-009	Rail Set (Pair): Guide and Telescopic Rails (complete set)
8	900-010	Key Holder

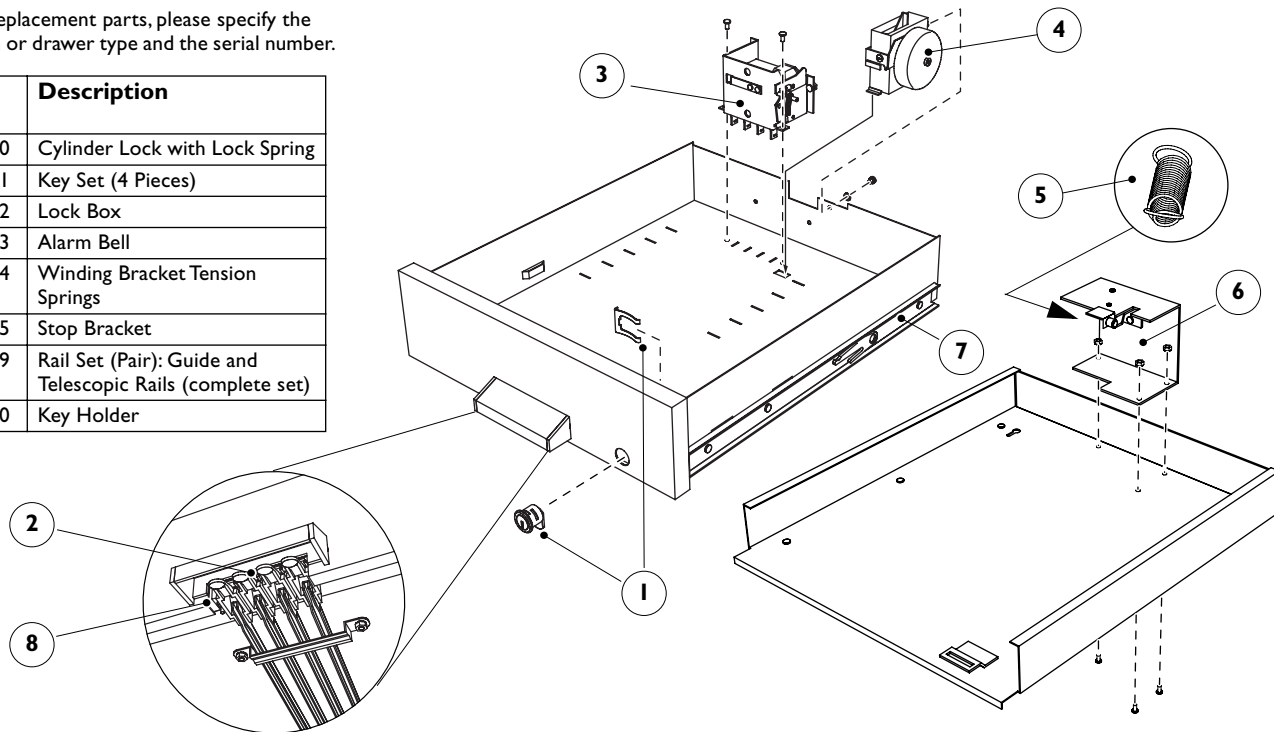

5.2 Accessories

Consult our catalogue for additional accessories such as drawer equipment and storage compartments for coins and banknotes.

To ensure optimum, trouble free operation of your product, we recommend that you only use the drawer inserts provided by Mogler GmbH.



We would be happy to advise you. Give us a ring!

Mogler-Kassen GmbH
Obere Mühle 17
D-74906 Bad Rappenau-Bonfeld, Germany
Phone +49 (0) 70 66 99 44-10
Fax +49 (0) 70 66 99 44-11

Internet: <http://www.mogler.de>
E-mail: technik@mogler.de

Printed in Germany
03/2002